

SECTION II

TM 5-2330-378-14&P

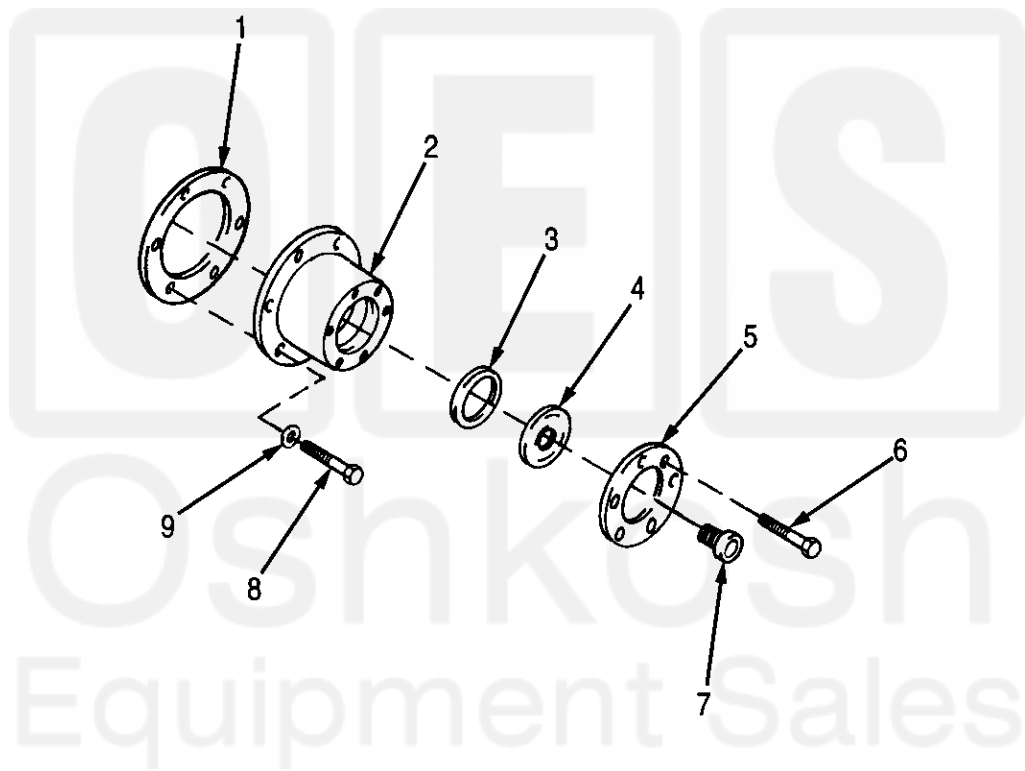

Figure 20. Wheel Assembly/Hub and Drum

SECTION II TM5-2330-378-14&P

(1) ITEM NO	(2) SMR CODE	(3) CAGEC	(4) PART NUMBER	(5) DESCRIPTION AND USABLE ON CODES (UC)	(6) QTY
GROUP 1311 WHEEL ASSEMBLY					
FIG.20 WHEEL ASSEMBLY/HUB AND DRUM					
1	PAOZZ	26151	3009	GASKET HUB CAP.....	6
2	PAOZZ	26151	343-4009	COVER,ACCESS.....	6
3	XBOZZ	26697	MP0-0541	GASKET.....	6
4	XAOZZ	26151	359-5994	WINDOW.....	6
5	PAOZZ	26697	MP0-0543	O-RING.....	6
6	PAOZZ	26697	MP0-0545	SCREW,MACHINE.....	6
7	PAOZZ	26151	5990	PLUG,VENT.....	6
8	PAOZZ	96906	MS90726-32	BOLT,MACHINE.....	6
9	PAOZZ	96906	MS35338-45	WASHER,LOCK.....	6

END OF FIGURE

